

Appendix **A**

County Road 4 Early Works Recommended Plan





COUNTY OF SIMCOE
TOWN OF BRADFORD WEST GWILLIMBURY

LIMIT OF COUNTY ROAD 4 WIDENING
STA. 9+415

LIMIT OF MTO
PROPOSED CONTROLLED
ACCESS HIGHWAY
STA. 9+600

LIMIT OF CONSTRUCTION
STA. 9+285

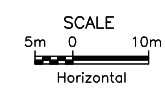
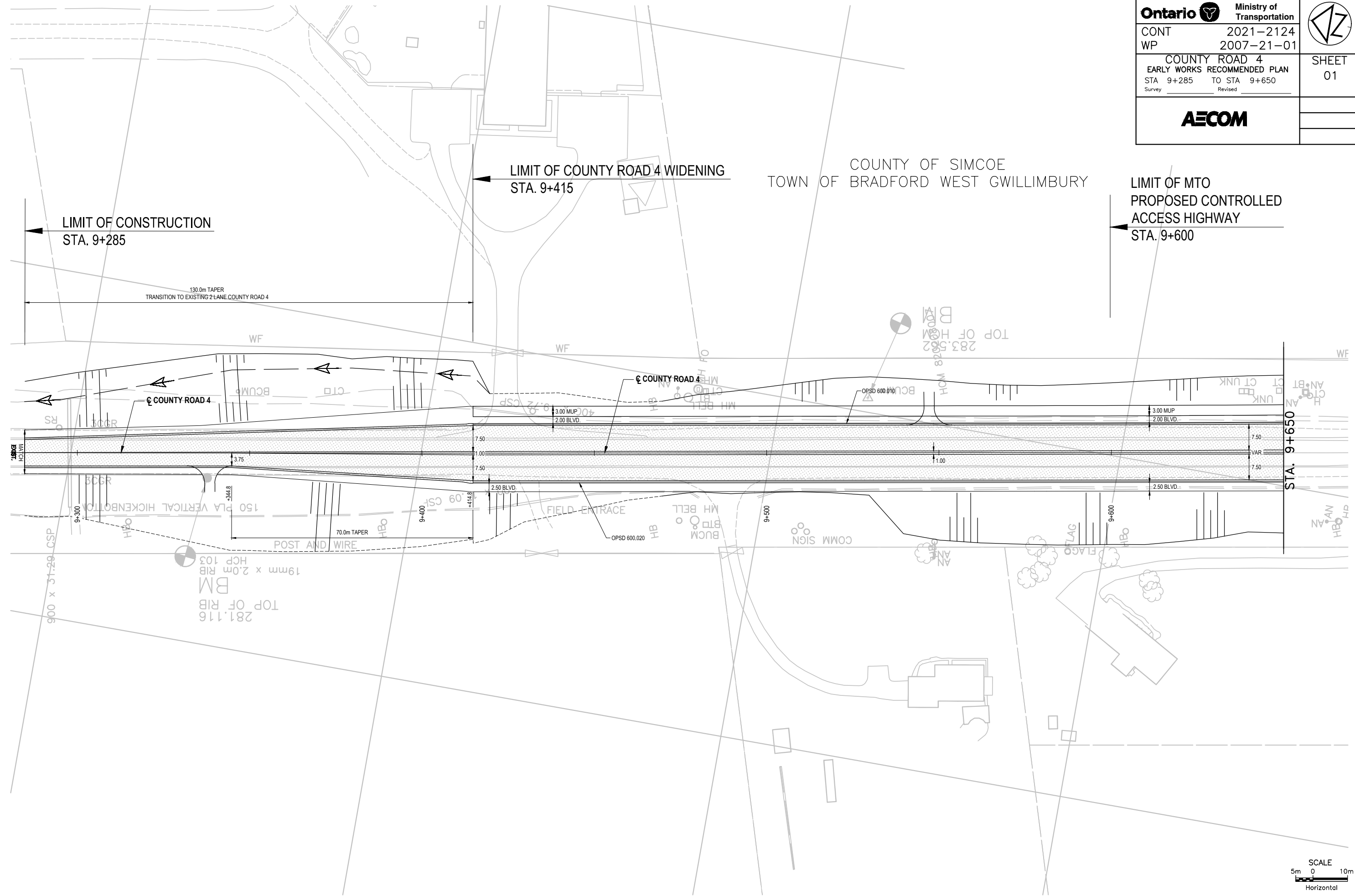



FILE NAME: Z:\Richmond Hill-CARH\DCS\Projects\TRM\60636190_Bradford\PASS\900_CAD_GIS\910_CAD\Sheets\C\County Road 4\NEW CONSTRUCTION For Early Work Report (EMR)\60636190-C-CONST-CR4_Sheet 1.dwg
CREATED: 2022-01-12 09:24
MODIFIED: 2022-01-12 09:24

2016-10
ANS-D
MINISTRY OF TRANSPORTATION, ONTARIO

FILE NAME: Z:\Richmond Hill-CARH\DCS\Projects\TRM\60636190_BradfordBypass\900_CAD_Sheets\C\County Road 4\NEW CONSTRUCTION For Early Work Report (EMR)\60636190-C-CONST-CR4_Sheet 2.dwg
CREATED: 2022-01-07
MODIFIED: 2022-01-07 13:03

2016-10
ANS-D
MINISTRY OF TRANSPORTATION, ONTARIO

COUNTY OF SIMCOE
TOWN OF BRADFORD WEST GWILLIMBURY

Ontario Ministry of Transportation		
CONT WP	2021-2124 2007-21-01	SHEET 02
COUNTY ROAD 4 EARLY WORKS RECOMMENDED PLAN STA 9+650 TO STA 10+000 Survey _____ Revised _____		

AECOM

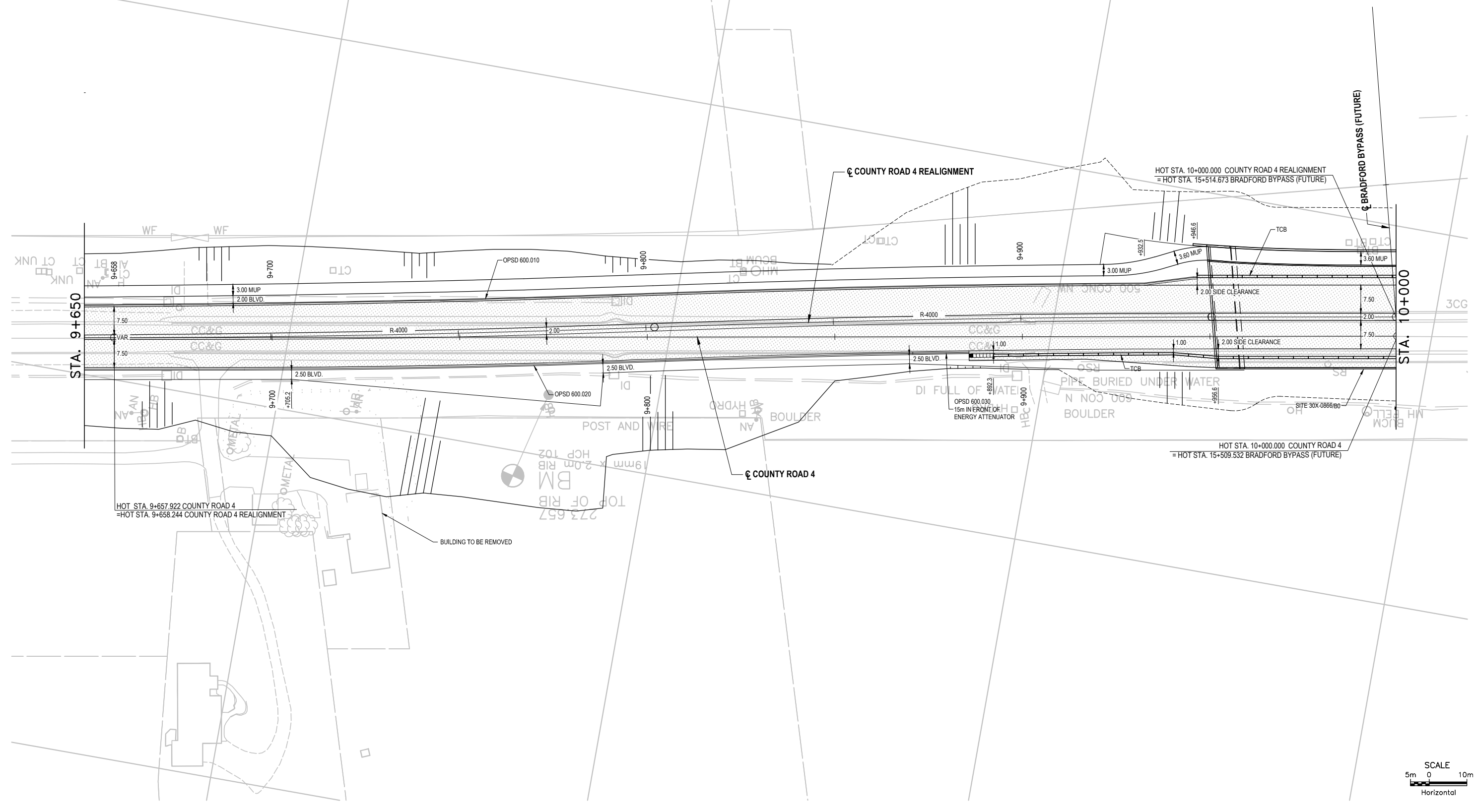

SCALE
5m 0 10m
Horizontal



COUNTY OF SIMCOE
TOWN OF BRADFORD WEST GWILLIMBURY

LIMIT OF MTO PROPOSED CONTROLLED ACCESS HIGHWAY
STA. 10+350

☉ COUNTY ROAD 4 REALIGNMENT

☉ COUNTY ROAD 4

HOT STA. 10+000.000 COUNTY ROAD 4
= HOT STA. 15+509.532 BRADFORD BYPASS (FUTURE)

HOT STA. 10+319.821 COUNTY ROAD 4
= HOT STA. 10+320.254 COUNTY ROAD 4 REALIGNMENT

☉ BRADFORD BYPASS (FUTURE)

1.25 x 0.90 x 35.77

BM
252.764
19mm x 2.0m RIB
HCP 100

BM
19mm x 2.0m RIB
HCP 101

OPSD 600.010

OPSD 600.030
15m IN FRONT OF
ENERGY ATTENUATOR

STA. 10+000

STA. 10+350

15+400

SCALE
5m 0 10m
Horizontal

FILE NAME: Z:\Richmond Hill-CARH\DCS\Projects\TRM\60636190_BradfordBypass\900_CAD_GIS\910_CAD_Sheets\C\County Road 4\NEW CONSTRUCTION For Early Work Report (EMR)\60636190-C-CONST-CR4_Sheet_3.dwg
CREATED: 2022-01-07 10:26
MODIFIED: 2022-01-07 10:26
2016-10
ANS-D
MINISTRY OF TRANSPORTATION, ONTARIO



COUNTY OF SIMCOE
TOWN OF BRADFORD WEST GWILLIMBURY

LIMIT OF COUNTY ROAD 4 WIDENING
STA. 10+460

LIMIT OF CONSTRUCTION
STA. 10+563

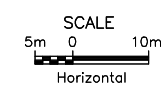
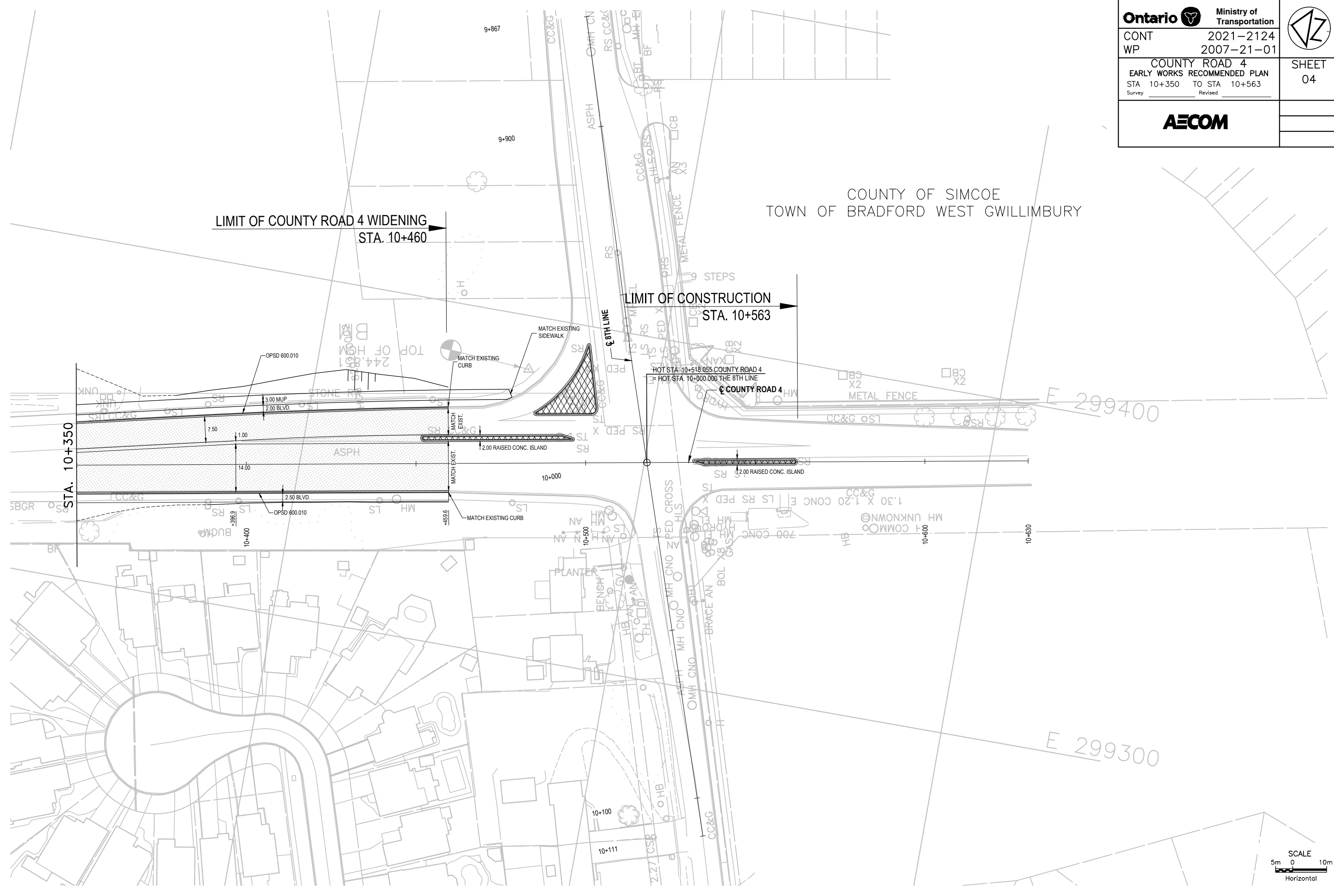

FILE NAME: Z:\Richmond Hill-CARH\DCS\Projects\TRM\60636190_Bradford\PASS\900_CAD_GIS\910_CAD_Sheets\C\County Road 4\NEW CONSTRUCTION For Early Work Report (EMR)\60636190-C-CONST-CR4_Sheet 4.dwg
 CREATED: 2022-01-07
 MODIFIED: 2022-01-07 10:29
 MINISTRY OF TRANSPORTATION, ONTARIO
 ANS-D
 2016-10



COUNTY OF SIMCOE
TOWN OF BRADFORD WEST GWILLIMBURY

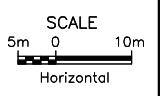
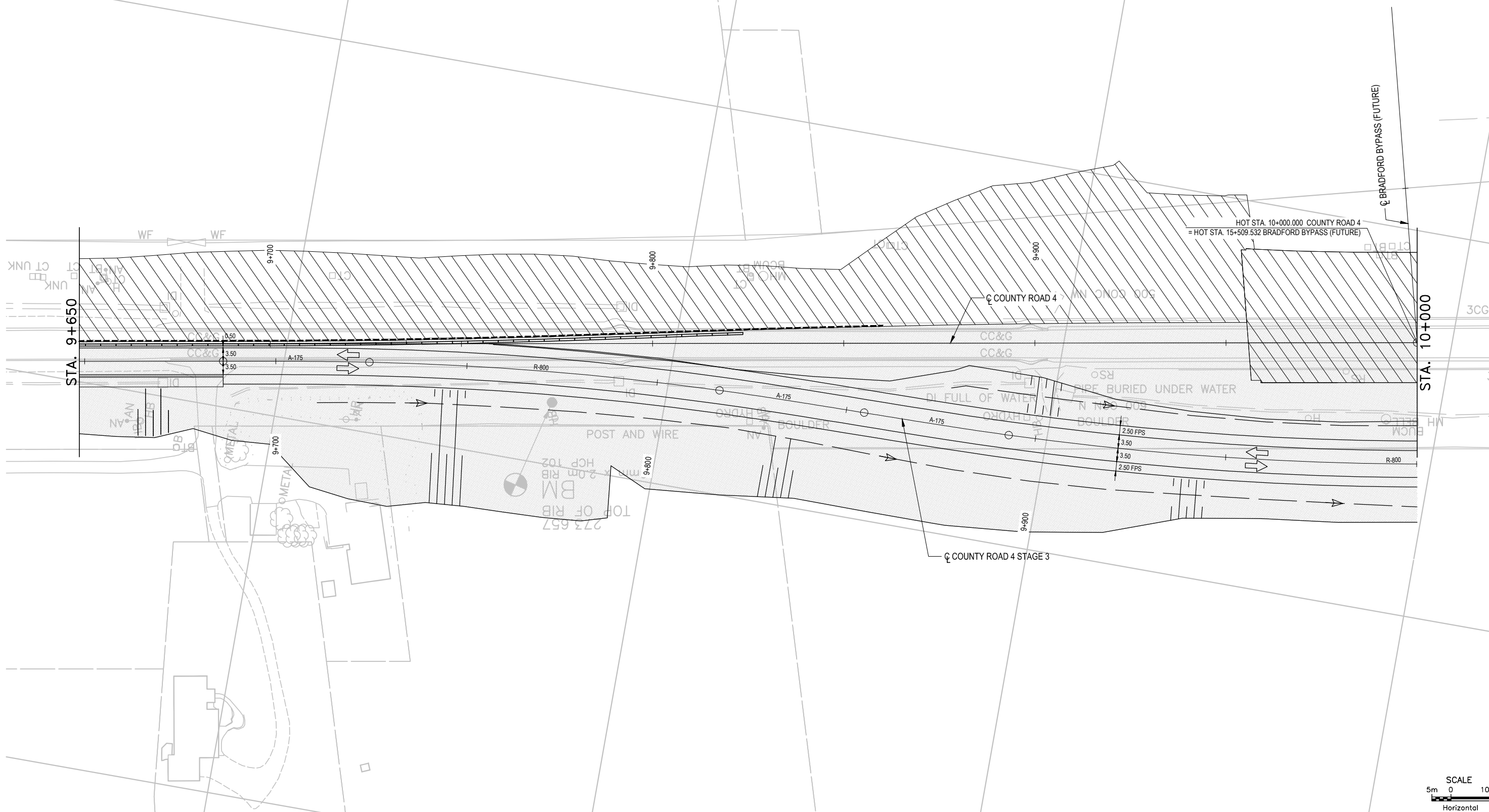

FILE NAME: Z:\Richmond Hill-CARH\DCS\Projects\TRM\60636190_BradfordByPASS\900_CAD_GIS\910_CAD_Sheets\C\County Road 4\CONSTRUCTION STAGING\For Early Work Report (EWR)\60636190-C-CR4_Detour 1.dwg
 CREATED: 2022-01-07 14:54
 MODIFIED: 2022-01-07 14:54

2016-10
 ANS-D
 MINISTRY OF TRANSPORTATION, ONTARIO



COUNTY OF SIMCOE
 TOWN OF BRADFORD WEST GWILLIMBURY

FILE NAME: Z:\Richmond Hill - CARCH1\DCS\Projects\TRN\60636190_BradfordBypass\900_CAD_GIS\910_CAD_Sheets\C_County Road 4\CONSTRUCTION STAGING\For Early Work Report (EWR)\60636190-C-CR4_Detour 2.dwg
 CREATED: 2022-01-07
 MODIFIED: 2022-01-07 13:00

